



ORKNEY

ISLANDS COUNCIL

**THE ORKNEY ISLANDS COUNCIL (VARIABLE
20 MPH SPEED LIMIT AND 30 MPH SPEED LIMIT
EXTENSION) (FINSTOWN) ORDER 2023**

Contents

THE ORKNEY ISLANDS COUNCIL (VARIABLE 20 MPH SPEED LIMIT AND 30 MPH SPEED LIMIT EXTENSION) (FINSTOWN) ORDER 2023	1
Contents.....	1
Introduction	2
Citation and Commencement	2
Interpretation	2
Speed Limit	2
Road Traffic Regulation Act 1984.....	3
Superseded Provisions	3
Schedule 1	4
Schedule 2	5

Introduction

Orkney Islands Council in exercise of its powers under Section 84 of the Road Traffic Regulation Act 1984 ("the Act"), and of all other enabling powers, and after consultation with the chief officer of police in accordance with Part III of Schedule 9 to the Act, hereby makes the following Order:

Citation and Commencement

1. This Order may be cited as The Orkney Islands Council (Variable 20 mph Speed Limit and 30 mph Speed Limit Extension) (Finstown) Order 2023 and shall come into operation on the Eighteenth day of March Two Thousand and Twenty Four.

Interpretation

2. The Interpretation Act 1978 shall apply for the interpretation of this Order as it applies for the interpretation of an Act of Parliament.

Speed Limit

3. (a) No person shall drive or cause or permit to be driven any motor vehicle in any of the lengths of road specified in Schedule 1 to this Order at a speed exceeding:
 - (i) Twenty miles per hour at a time when such a speed limit is indicated by a traffic sign in accordance with Article 3(b) hereof; or
 - (ii) Thirty miles per hour at any other time.
- (b) Such an indication may be given between the hours of 7:30am and 5:00pm on Mondays to Fridays inclusive, and at no other time.
4. No person shall drive or cause or permit to be driven any motor vehicle at a speed exceeding thirty miles per hour in any of the lengths of road specified in Schedule 2 to this Order.

Road Traffic Regulation Act 1984

5. The restrictions imposed by this Order shall be in addition to and not in derogation of any restriction or requirement imposed by any regulations made or having effect as if made under Road Traffic Regulation Act 1984 or by and under any other enactment.

Superseded Provisions

6. This Order, where its provisions conflict, supersedes:
- a) The Orkney Islands Council (Variable 20 mph Speed Limit) (Schools in Evie and Firth) Order 2007 which came into operation on the First day of April Two Thousand and Seven.

Given under the seal of Orkney Islands Council on the Thirtieth day of January Two Thousand and Twenty Four.



A handwritten signature in blue ink, consisting of a large loop followed by a horizontal line.

Gavin Rattray Mitchell
Head of Legal and Governance

Schedule 1

1.

- a) That part of the public road A966 from its junction with the A965 in Finstown village centre, proceeding firstly in a northerly direction and thereafter in a northeasterly direction to a point at the southwestmost corner of the property known as Govilon, a total distance of five hundred and eighty metres or thereby.

All as shown in red on Plan 1 annexed and executed as relative to this order.

2.

- (a) That part of the public road A965 from its junction with the A966 in Finstown village centre, proceeding in a southeasterly direction, to a point five metres or thereby southeast of the northeastmost corner of the garden of the property known as Tigh-Na-Mara, a total distance of two hundred and fifteen metres or thereby.

All as shown in red on Plan 1 annexed and executed as relative to this order.

3.

- a) That part of the public road A965 from its junction with the A966 in Finstown village centre, proceeding firstly in a northwesterly direction and thereafter in a westerly direction, to a point five metres or thereby west of its junction with Grandon Road, a total distance of two hundred and ninety metres or thereby.

All as shown in red on Plan 1 annexed and executed as relative to this order.



Gavin Rattray Mitchell
Head of Legal and Governance



Schedule 2

1.

- a) That part of the public road A966 from the existing point nine metres or thereby, northeast of the northwestmost corner of the Telephone Exchange, Finstown, in a northeasterly direction to a point five metres or thereby northeast of the entrance to the property known as Heddon House, a total distance of six hundred or thereby.

All as shown in red on Plan 2 annexed and executed as relative to this order.

2.

- (a) That part of the public road A965 from the existing point forty six metres or thereby of southeastmost corner of the entrance to the property known as The Boathouse, proceeding in a southeasterly direction, to a point twenty three metres or thereby east of the eastern entrance to the property known as Atlantis Lodges, a total distance of two hundred metres or thereby.

All as shown in red on Plan 3 annexed and executed as relative to this order.

3.

- a) That part of the public road C1 Old Finstown Road from a point at the northwestmost corner of the entrance to the property known as Avallon, proceeding in a southeasterly direction to a point five metres or thereby southeast of the entrance to the property known as Lindean, a total distance of two hundred metres or thereby.

All as shown in red on Plan 4 annexed and executed as relative to this order.



Gavin Rattray Mitchell
Head of Legal and Governance

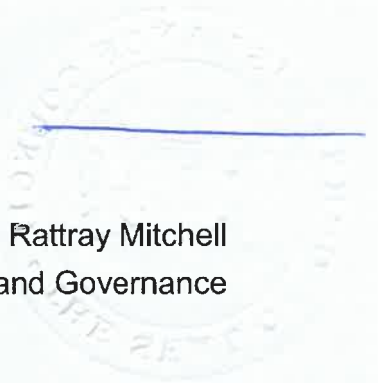

-

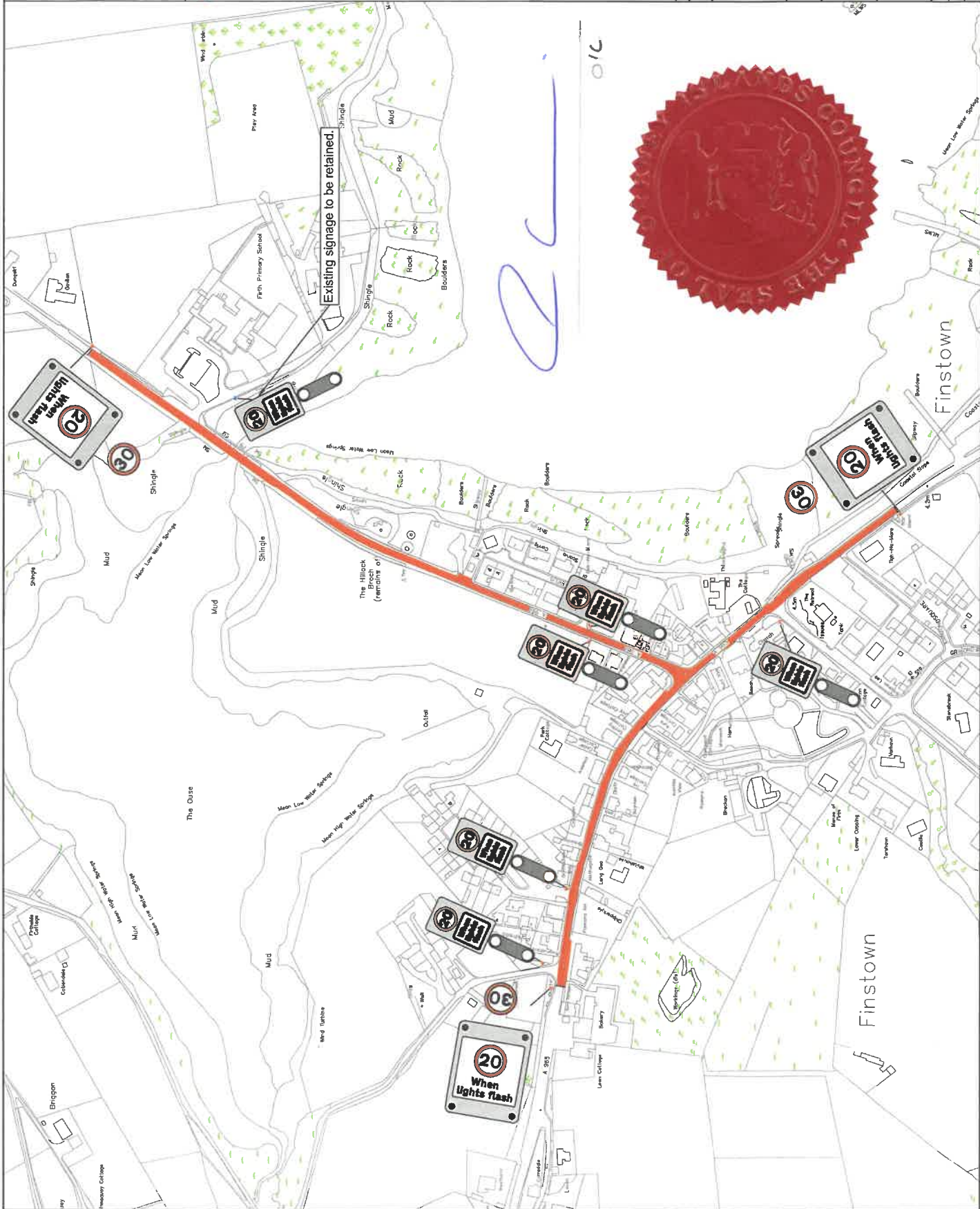
[illegible]

A detailed map of the University of Toronto campus. The map shows the University of Toronto Library, the University of Toronto Press, and the University of Toronto Press building. The map is oriented with North at the top. The University of Toronto Library is located on the left side of the map, and the University of Toronto Press is located on the right side. The University of Toronto Press building is located at the bottom of the map. The map also shows the University of Toronto Press building, the University of Toronto Press building, and the University of Toronto Press building. The map is a black and white line drawing.

A detailed map of the coastal area around Finstown, Victoria, Australia. The map shows the coastline with several small bays and inlets. The town of Finstown is located on the coast, with a road running along the shore. The Finstown Hotel is marked with a red dot and labeled. Other features include the 'Murray River' and 'Murray River Bridge'.

Notes:

1. Do not scale from this drawing.
2. All dimensions are in metres unless otherwise noted.
3. All proposed signage shall be erected within the existing highway boundary.

Key:

Extension of 30mph speed limit on A966 by approximately 600m.

PLAN 2

A	20000723	Changed the position of the sign after automatic tests the system	201	201	201
Year	Date	Revision notes	Drawn	Checked	IT

© This drawing is the property of SYSTRA Limited and the information

© This drawing is the property of SYSTRA Limited and the information can only be reproduced with their prior permission.

SYSTRA
www.systra.co.uk

Centrum House,
38 Queen Street,
Glasgow, G1 3DX
T 0141 468 4285
F 0800 066 4367
E UK.Scotland@syntra.co.uk

Client
Orkney Islands Council

Project
Finstown Traffic Management Study

Proposed 30mph Speed Limits

A966
Sheet 1 of 3

Quinn	SH	Classified	SL	Approved	SL
Original app. date	A3	Date	Feb '23	Score	1:2000
Library Status	Preliminary		Control Number	GB01T21F18(P)/GL/30/01 A	
				REV	

- Notes:

1. Do not scale from this drawing.
2. All dimensions are in metres unless otherwise noted.
3. All proposed signage shall be erected within the existing highway boundary.

Key:

Extension of 30mph speed limit on A965 East by approximately 675m.

PLAN 3

Ref	Code	Inventory length	Items	Quoted

© This drawing is the property of SYSTRA Limited and the information contained herein is confidential.

SYSTRA
www.systra.co.uk

Centrum House,
38 Queen Street,
Glasgow G1 3DX
T 0141 468 4205
F 0800 865 4367
E UK_Softswitch@centrum.co.uk

Orkney Islands Council

Finstown Traffic Management Study

Proposed 30mph Speed Limits
A965 East
Sheet 2 of 3

Drawn	SH	Checked	SL	Approved	SL
Original copy in file	A3	Date	Sep '22	Scale	1:2000
Drawing Status		Drawing Number		Rev	
Preliminary		GB0121F18/PL/GJ30/02			

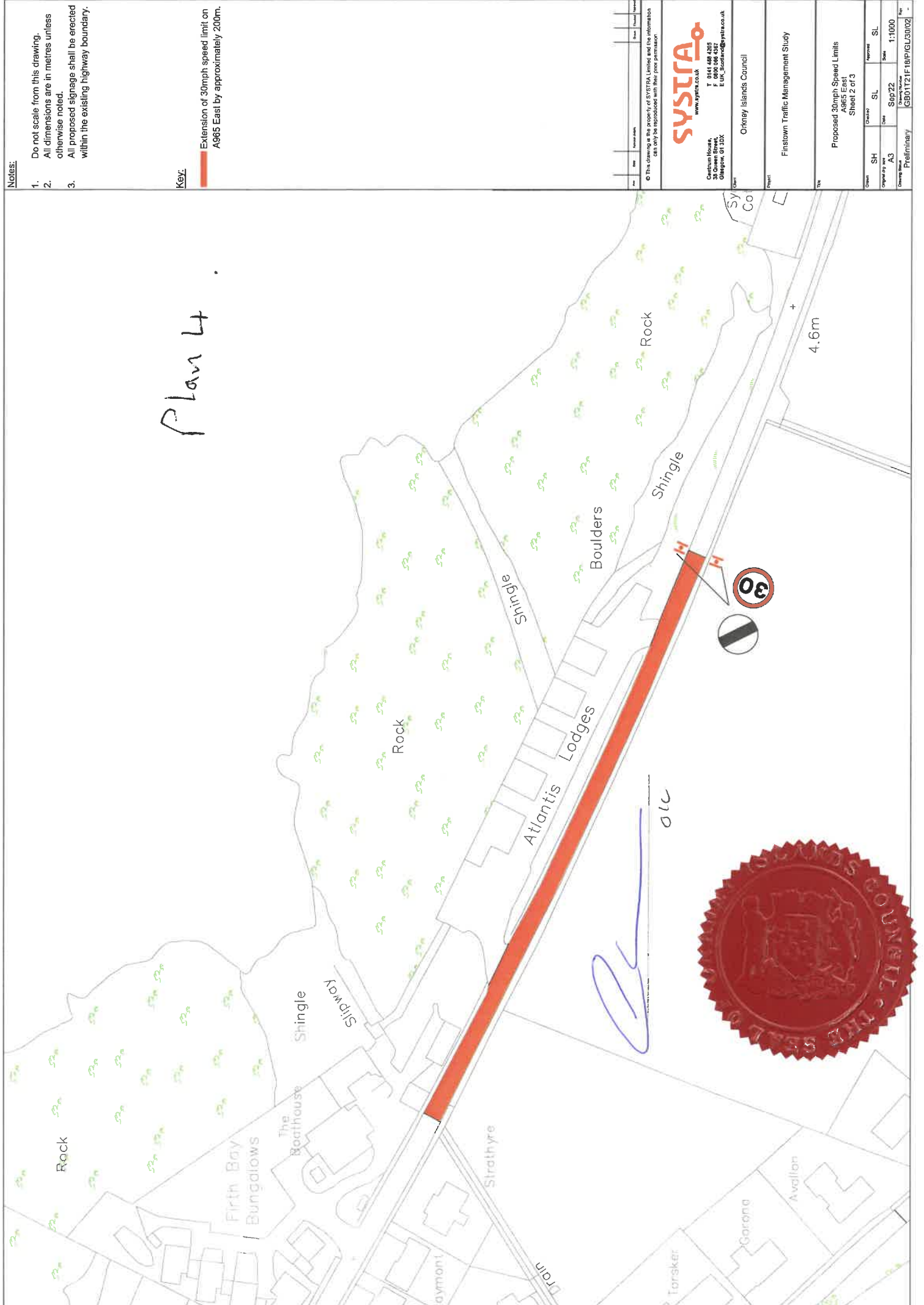

Plan 4

Notes:

1. Do not scale from this drawing.
2. All dimensions are in metres unless otherwise noted.
3. All proposed signage shall be erected within the existing highway boundary.

Key:

Extension of 30mph speed limit on A965 East by approximately 200m.

Author	Drawn	Checked	Approved	Issue	Revised
© This drawing is the property of SYSTRA Limited and the information contained herein is for the use of the client only. No part of this drawing may be reproduced without the prior permission of SYSTRA Limited.					
SYSTRA www.systra.co.uk T 0144 488 1205 F 0144 488 1206 E UK_Sales@systra.co.uk					
Cartman House, 100, The Quadrant, Glasgow, G1 2DX.					
Client	Orkney Islands Council				
Project	Finstown Traffic Management Study				
Title	Proposed 30mph Speed Limits A965 East Sheet 2 of 3				
Drawn	SH	SL	SL	SL	SL
Original Date	A3	S0522	SL	SL	SL
Drawing Number	Preliminary				
Scale	1:1000				
Revision	GB0121F18P/GU002				

