





Reproduced by permission of Ordnance Survey on behalf of HMSO.
 © Crown copyright and database right 2018. All rights reserved.
 Ordnance Survey License number 100021621.



**THE ORKNEY ISLANDS COUNCIL
 (VARIABLE 20MPH SPEED LIMIT)
 (PICKAQUOY ROAD, KIRKWALL)
 ORDER 201()**

Key:

-  Existing Variable 20mph zone covered by existing order:-
The Orkney Islands Council (Variable 20mph Speed Limit) (Schools in Kirkwall and Stromness) Order 2005
-  175m Extension to variable 20mph zone
-  Existing full size flashing 20mph sign to be relocated.
-  Relocated full size 20mph sign
-  New small size 20mph sign

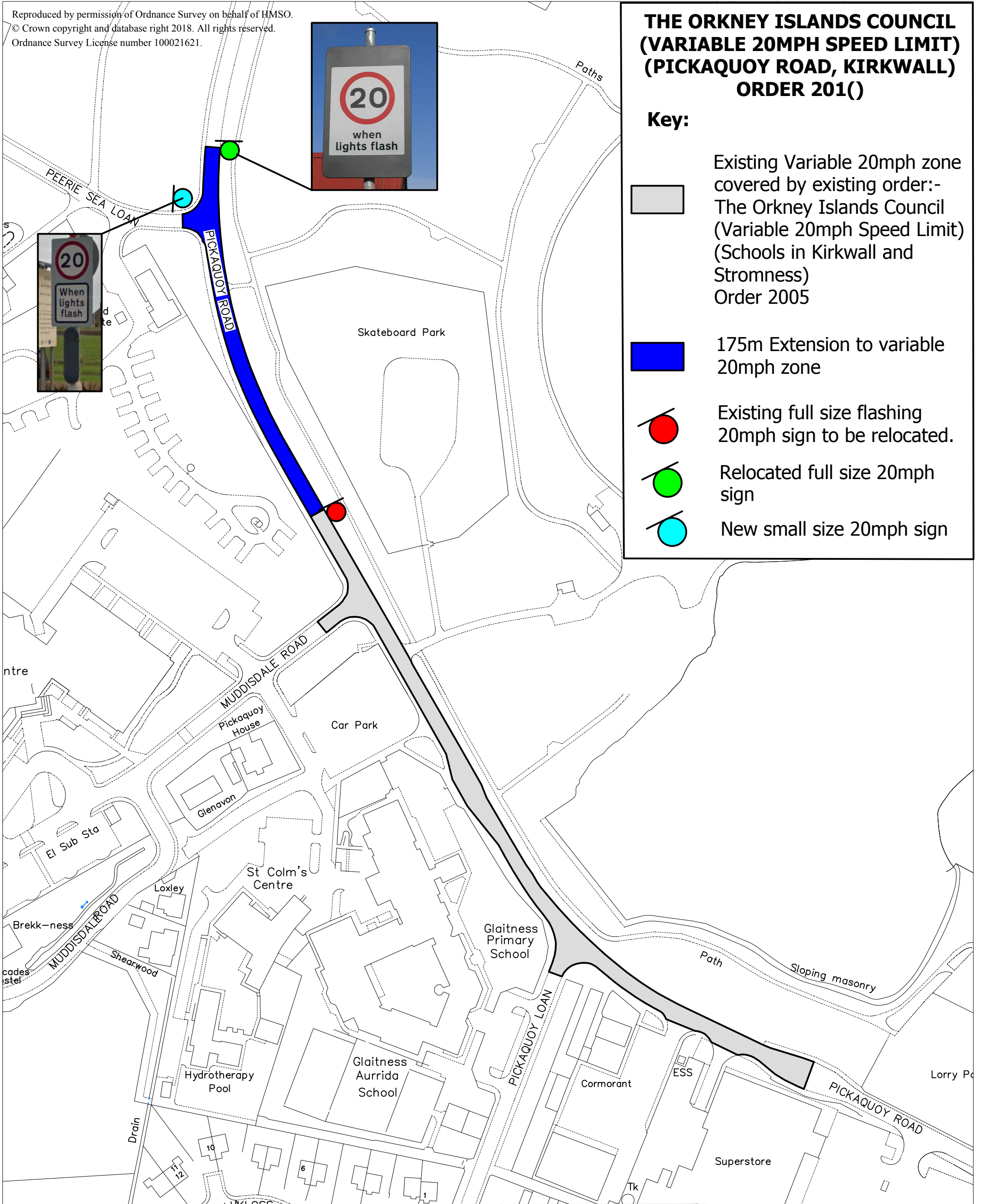

File Ref. R3.27.04	Drawing No. Pickaquoy-01
Revision	
Date 19th July 2018	Drawn <i>J.Coyle</i>
Scale NTS	Checked <i>K.D.Roy</i>

**THE ORKNEY ISLANDS COUNCIL
 (VARIABLE 20MPH SPEED LIMIT)
 (PICKAQUOY ROAD, KIRKWALL)
 ORDER 201()**

**Roads
 Services**

DEVELOPMENT AND INFRASTRUCTURE
 Council Offices, Kirkwall
 Orkney, KW15 1NY
 tel (01856) 873535
 fax (01856) 876094



Executive Director :-
 Gavin Barr
 BSc Hons MSc URP MRTPI

ORKNEY ISLANDS COUNCIL